

PST

LED ROUND POST TOP

CCT AND 3 POWER SELECTABLE

7 PIN RECEPTACLE AND SHORTING CAP

The PST round LED post top luminaire offers a contemporary and elegant look making it a great addition to applications where energy efficiency, performance and design are essential. Typical applications include urban streets, walkways, parks, shopping malls, residential areas, and campuses.



FEATURES & SPECIFICATIONS

CONSTRUCTION

Physical Characteristics

- Die-cast aluminum housing comes standard in a black powder coated finish
- All configurations come standard with a 7 pin receptacle and shorting cap
- Easy access to color temperature and power select switch

Mounting

- The post top arm accommodates 2-3/8" and 3" tenons
- Slipfitter and Square/Round pole arm as accessories

Optics

- Type V distribution that provides wide uniform light output

PERFORMANCE DATA

- Available in both 3 000/4 000/5 000 K color temperatures for PS75 lumen package and 4 000/5 000 K for PS100 lumen package
- 80+ CRI for true color accuracy
- Electrical ratings: 120-347 V
- Estimated life of over 50 000 hours to L70
- 0-10 V dimming standard
- Operating temperature: -40 °C to +45 °C
- 6Kv Surge Protection

COMPLIANCES

- cULus listed for wet locations
- Meets requirements of ICES-005 issue 5 class B for use in residential applications
- IP65
- IK08
- DLC Premium

OVERVIEW			
LIGHT SOURCE	LED	EFFICIENCY (LM/W)	120 - 347
WATTS (W)	50/60/75 100/120/150	COLOR TEMPERATURE (K)	3 000/4 000/5 000 4 000/5 000
LUMEN OUTPUT (LM)	6 750 - 10 125 13 5000 - 20 200	CRI	80+

Data is based upon tests performed in a controlled environment. Actual performance can vary depending on operating conditions. All products are subject to change or may be discontinued any time without notice.

QUICK SHIP ORDERING GUIDE



PART NO	WATTS [W]	VOLTS [VAC]	COLOR TEMP. [K] ¹	LUMEN OUTPUT [LM] ^{2,3}	EFFICACY [LM/W]	CRI	LIFE L70 [HRS] ⁴	DISTRI- BUTION TYPE	B.U.G.	EPA [FT²]	FINISH	DIMMING [YES/NO]	PF	THD [%]	MASTER CASE QTY
PSTPS755323CBKPR7	50/60/75	120-347	30/40/50K	6 750/8 100/ 10 125	135	80+	50 000	Type V	B3-U0-G3	1.48	Black	Yes	0.90	20	1
PSTPS1505322CBKPR7	100/120/150	120-347	40/50K	13 500/16 200/20 200	135	80+	50 000	Type V	B3-U0-G3	1.48	Black	Yes	0.90	20	1

¹ Typical color temperature range: +/- 5 %.

² Lumen values are derived from photometric testing. Initial lumens range: +/- 10 %.

³ Lumen values are based on 4 000 K default programming. Please refer to the LUMEN SPECIFICATION TABLE for more details on other color temperatures.

⁴ Life hours are derived from IESNA LM-80-08 testing report and projected per IESNA TM-21-11 extrapolations.

DLC UNIQUE ID TABLE

PART NO	DLC PREMIUM UNIQUE ID ¹
PSTPS755323CBKPR7	S-R432DQ
PSTPS1505322CBKPR7	IN PROCESS

¹ Primary Use Designation: Outdoor Pole/Arm-Mounted Area and Roadway Luminaires

QUICK SHIP SPECIFICATION TABLE

PART NO	WATTS [W]	VOLTS [V]	3 000 K		4 000 K		5 000 K	
			LUMEN OUTPUT [LM]	EFFICACY [LM/W]	LUMEN OUTPUT [LM]	EFFICACY [LM/W]	LUMEN OUTPUT [LM]	EFFICACY [LM/W]
PSTPS755323CBKPR7	50/60/75	120-347	9 750	130	10 500	140	10 125	135
PSTPS1505322CBKPR7	100/120/150		N/A	N/A	21 300	142	20 700	138

DEFAULT PROGRAMMING

PSTPS755323CBKPR7	75 W / 4 000 K
PSTPS1505322CBKPR7	150W / 4 000 K

ACCESSORIES (ORDER SEPARATELY)

PART NO	TYPE
CAS1011-SWIVEL-BK	Slipfitter
CAS1011-RNDSQBK	Square/Round pole arm



SLIPFITTER



SQUARE/ROUND POLE ARM

EPA VALUES [FT²]

LUMINAIRE WITH SLIPFITTER MOUNT

WATTS [W]					
75W, 150W	2.09	4.18	4.18	5.58	6.99

LUMINAIRE WITH SQUARE/ROUND POLE ARM MOUNT

WATTS [W]					
75W, 150W	2.30	4.58	4.58	6.19	7.80

CHANGE YOUR MOUNTING TYPE IN 3 SIMPLE STEPS¹

Step 1: Remove the post top arm



Step 2: Choose the desired mounting



Slipfitter

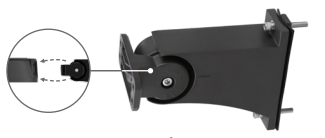

Square/Round pole arm

Step 3: Install the new luminaire onto the pole.



¹ Refer to the installation instruction for more details

COMPATIBLE DIMMERS¹

BRAND	MODEL
Leviton	DS710, IP710
Lutron	NTSTV-DV, DVSTV, DVTV-WH
Legrand	RH4FBL3PW

Dimming range: 0%-100%

¹ This table shows dimmers that have been tested and have demonstrated proper operation under normal conditions. Each installation being unique, various factors such as load, common neutrals or other electrical products on the circuit can, in certain instances, cause variance in system performance. Read and comply to the dimmer installation instructions. Consult dimming system manufacturer for additional support in operation. Some dimmers may require more than one product for stable operation. Aimlite recommends to use dimmers designed to work with LED products. Older dimmers designed for incandescent products may cause erratic operation.

DRILLING PATTERN

CAS1011-RNDSQBK

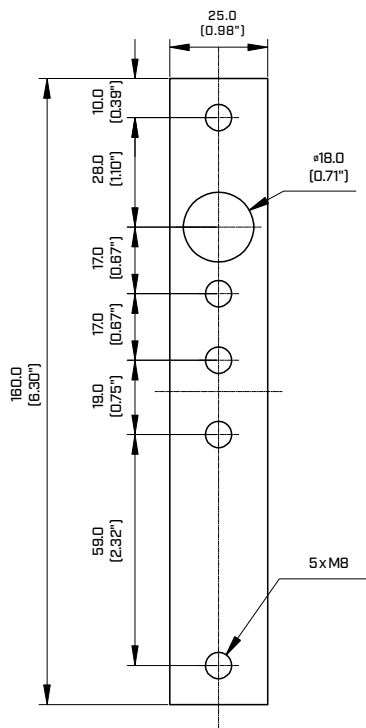

DIMENSIONS AND WEIGHTS

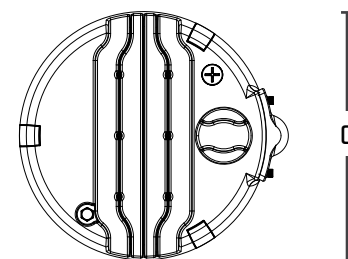
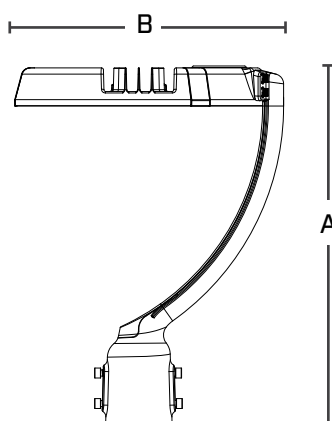

	PS75, PS150
A in. [cm]	18.31" [465mm]
B in. [cm]	13.9" [353mm]
C in. [cm]	12.8" [325mm]
Net weight [lbs]	9.46

PHOTOMETRIC DATA¹

PSTPS755323CBKPR7 • 75 W • 4 000 K • 11 518 LM

POLAR CANDELA DISTRIBUTION

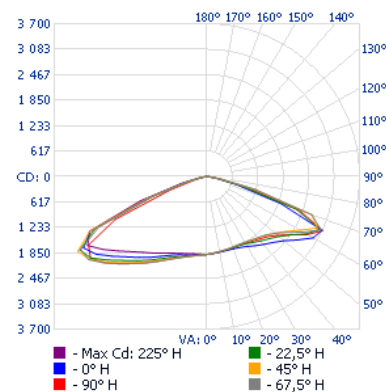

ZONAL LUMEN SUMMARY

ZONE	LUMENS	% FIXTURE
0-30	1 658.7	14.4%
0-40	3 047.8	26.5%
0-60	7 616.7	66.1%
60-90	3 810.1	33.1%
70-100	1 060.3	9.2%
90-120	35.7	0.3%
0-90	11 426.9	99.2%
90-180	91.6	0.8%
0-180	11 518.4	100%

ILLUMINANCE AT A DISTANCE

CENTER BEAM FC		BEAM WIDTH	
17.0'	6.53 FC	68.8'	58.1'
34.0'	1.63 FC	137.6'	116.3'
51.0'	0.73 FC	206.4'	174.4'
68.0'	0.41 FC	275.2'	232.5'
85.0'	0.26 FC	344'	290.7'
102.0'	0.18 FC	412'	348.8'

■ Vert. Spread: 127.4° ■ Hor. Spread: 119.4°

PSTPS1505322CBKPR7 • 150 W • 4 000 K • 20 937 LM

POLAR CANDELA DISTRIBUTION

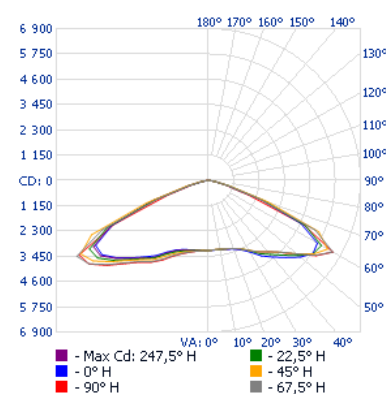

ZONAL LUMEN SUMMARY

ZONE	LUMENS	% FIXTURE
0-30	2 899.5	13.8%
0-40	5 535.6	26.4%
0-60	14 770.2	70.5%
60-90	6 166.4	29.5%
70-100	1 398.5	6.7%
90-120	0	0%
0-90	20 936.6	100%
90-180	0	0%
0-180	20 936.6	100%

ILLUMINANCE AT A DISTANCE

CENTER BEAM FC		BEAM WIDTH	
17.0'	11.0 FC	45.8'	66.9'
34.0'	2.76 FC	91.7'	133.7'
51.0'	1.23 FC	137.5'	200.6'
68.0'	0.69 FC	183.4'	267.5'
85.0'	0.44 FC	229.2'	334.3'
102.0'	0.31 FC	275.1'	401.2'

■ Vert. Spread: 106.9° ■ Hor. Spread: 126.1°

¹ Complete IES files available on our website.